

**PJH - Uzun Boru Bağlantı / Extended Tube Splicer**



**Ölçü Tablosu / Dimension Chart**

MODEL	B	C	ØD1	ØD2	ØD3	ØF1	ØF2	L1	L2	Ağırlık (g) Weight (g)	Adet/Kutu Qty / Box
PJH 04 -04	36	16	4	4.8	5.9	2	2	18	17	0.9	100
PJH 04 -05	36	16	4	6	6.9	2	4.2	18	17	0.8	100
PJH 06 -05	41	17	6	5.9	6.9	4	4	23	17	1.1	100
PJH 06 -06	41	17	6	6.8	7.9	4	4	23	17	1.4	100
PJH 08 -06	43	18.5	8	6.8	7.9	6	4	25	17	1.7	100
PJH 08 -08	48.2	18.5	8	8.6	10	6	6	25	22	2.3	100
PJH 10 -08	50.2	21	10	8.6	10	8	6.2	27	22	2.7	100
PJH 12 -08	54.2	22.5	12	8.6	10	10	6.2	31	22	2.8	100
PJH 12 -10	54.7	22.5	12	10.6	12	10	8	31	22.5	3.1	50
PJH 12 -13	55	22.5	12	13.5	15	10	10	31	22.5	5	50
PJH 14 -14	59.5	24.5	14	14.7	16	12	10	35.5	22.5	5.8	50
PJH 04-1/8	36	16	4	3.8	5	2	2	17	17	0.5	100
PJH 08-1/4	43	18.5	8	7.3	8.5	6	4.6	24	17	1.7	100
PJH 10-1/4	45.2	21	10	7.3	8.5	8	4.6	26	17	2.3	100
PJH 12-1/2	55	22.5	12	13.2	14.5	10	10	30	22.5	4.7	50
PJH 14-1/2	59.5	24.5	14	13.2	14.5	12	10	34.5	22.5	4.8	50

**Teknik Çizim / Technical Drawing**

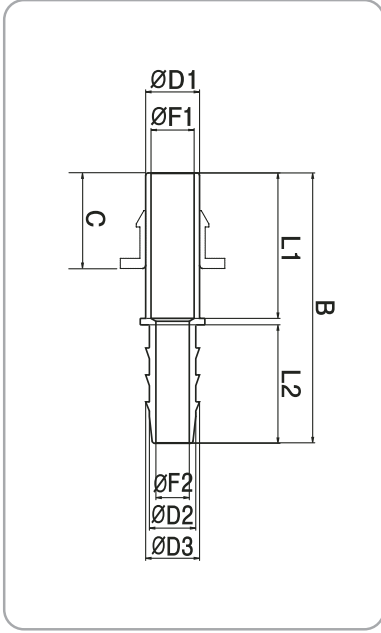

**PIG - Düşürücü Boru Bağlantı / Reducer Tube Splicer**



**Ölçü Tablosu / Dimension Chart**

MODEL	ØD1	ØD2	B	C1	C2	Orifis (mm) Orifice (mm)	Ağırlık (g) Weight (g)	Adet/Kutu Qty / Box
PIG 06-04	6	4	36	17	16	2	0.7	100
PIG 08-04	8	4	38	18.9	18	2	0.9	100
PIG 08-06	8	6	39	18.5	17	4	1.5	100
PIG 10-06	10	6	42	21.9	19	4	1.6	100
PIG 10-08	10	8	43	21	18.5	5	2.8	100
PIG 12-08	12	8	45	23.9	20	5	2.6	50
PIG 12-10	12	10	48	22.5	21	5.5	4.9	50
PIG 16-12	16	12	54	24.8	22.5	9	8.2	50

**Teknik Çizim / Technical Drawing**

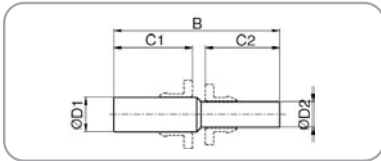

**PP - Kör Tapa / Plug**



**Ölçü Tablosu / Dimension Chart**

MODEL	ØD	B	ØP1	ØP2	C	Ağırlık (g) Weight (g)	Adet/Kutu Qty / Box
PP 04	4	28	3	4	16	0.4	100
PP 06	6	32	4	6	17	0.7	100
PP 08	8	39	5	8	18.5	1.4	100
PP 10	10	42	8	10	21	2	50
PP 12	12	44	8	12	22.5	3.6	50
PP 16	16	46	10	16	24.8	4	25

**Teknik Çizim / Technical Drawing**

