

Push-in Fittings

WPZT SERIES



Product features

- It's made of copper pneumatic piping joints
- Not only the body but also the sleeve, both of them are made from copper, which is good for flame resistance, heat resistance and splash performance

Speciality

Operating Temperature	-20~+80°C
Operating Pressure	0-1.0MPa
Fluid	Aia, Vacuum
Applicable Tube	Polyurethane and Nylon

Dimension

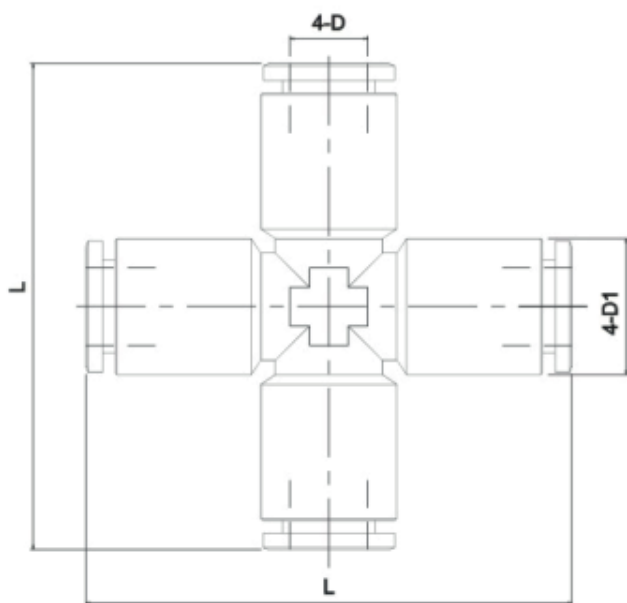

MODEL	ϕD	$\phi D1$	L
WPZT 04	4	8.5	35
WPZT 06	6	12	48.5
WPZT 08	8	14	54
WPZT 10	10	16	58
WPZT 12	12	18	63.5