

## SANG-A GNSH-G Serisi Tornavida Ayarlı Dirsek Hız Ayar Bağlantılar

Elbow G-Thread

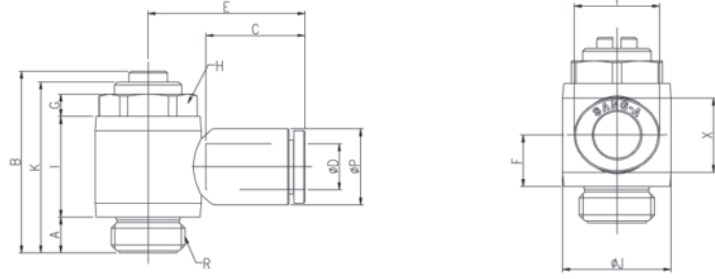

### Boyutlar

MODEL [ØD-T] Tube: (Metric) - Thread: (G)

MODEL	ØD	R	ØP	A	B	C	E	F	G	H	I	ØJ	K	X	Y	W.G(g)	Q'ty/ inbox
GNSH 04G01	4	G1/8	9	5	30	14.5	21.5	7.3	4	13	14.5	14	28.5	8.6	10.8	19.2	50
GNSH 04G02	4	G1/4	9	6	32.5	14.5	24	9	4	16	18	19	30.6	8.6	10.8	31.3	50
GNSH 04G03	4	G3/8	9	7	45.2	14.5	25.7	10.5	6.5	20	21	22.4	42.5	8.6	10.8	71.2	25
GNSH 06G01	6	G1/8	11.2	5	30	15.5	22.5	7.3	4	13	14.5	14	28.5	11	13	19.9	50
GNSH 06G02	6	G1/4	11.2	6	32.5	15.5	25	9	4	16	18	19	30.6	11	13	32.1	50
GNSH 06G03	6	G3/8	11.2	7	45.2	15.5	26.7	10.5	6.5	20	21	22.4	42.5	11	13	72.0	25
GNSH 08G01	8	G1/8	13.6	5	30	17.8	25.6	8	4	13	14.5	14	28.5	13	15	21.2	50
GNSH 08G02	8	G1/4	13.6	6	32.5	17.8	28.1	9	4	16	18	19	30.6	13	15	33.4	50
GNSH 08G03	8	G3/8	13.6	7	45.2	17.8	29.8	10.5	6.5	20	21	22.4	42.5	13	15	72.4	25
GNSH 08G04	8	G1/2	13.6	8.5	51.7	17.8	32.1	11	7	24	22	27	49	13	15	103.8	20
GNSH 10G02	10	G1/4	16.3	6	32.5	19.4	28.9	9.7	4	16	18	19	30.6	16	18.5	36.3	25
GNSH 10G03	10	G3/8	16.3	7	45.2	19.4	30.6	10.5	6.5	20	21	22.4	42.5	16	18.5	74.4	25
GNSH 10G04	10	G1/2	16.3	8.5	51.7	19.4	32.9	11	7	24	22	27	49	16	18.5	104.9	20
GNSH 12G03	12	G3/8	19.7	7	45.2	22.4	35.9	11.9	6.5	20	21	22.4	42.5	19.5	22.5	78.8	25
GNSH 12G04	12	G1/2	19.7	8.5	51.7	22.4	38.2	11.9	7	24	22	27	49	19.5	22.5	109.3	20