

SANG-A GPC-G Serisi Rekor Bağlantılar

Male Straight

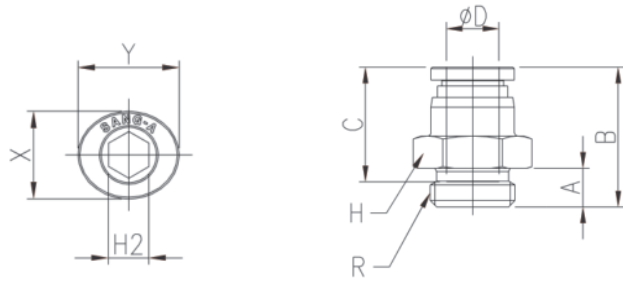
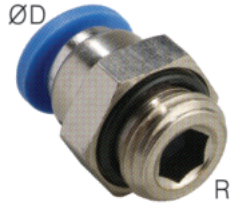

Boyutlar

MODEL [ØD-T] Tube: (Metric) - Thread: (G)

(mm)

MODEL	ØD	R	A	B	C	H1	H2	X	Y	Orifice (Ømm)	W.G(g)	Q'ty/ inbox
GPC 04G01	4	G1/8	5	18.4	14.5	13	3	8.6	10.8	3	8.4	100
GPC 04G02	4	G1/4	6	18.1	14.5	16	3	8.6	10.8	3	14.3	100
GPC 04G03	4	G3/8	7	18.1	14.5	20	3	8.6	10.8	3	24.1	50
GPC 06G01	6	G1/8	5	23.1	15.5	13	4	11	13	4	10.7	100
GPC 06G02	6	G1/4	6	19.8	15.5	16	4	11	13	4	14.2	100
GPC 06G03	6	G3/8	7	18.8	15.5	20	4	11	13	4	23.1	50
GPC 06G04	6	G1/2	8.5	19.3	15.5	24	4	11	13	4	42.9	50
GPC 08G01	8	G1/8	5	26	17.8	13	5	13	15	5	12.5	50
GPC 08G02	8	G1/4	6	21.7	17.8	16	6	13	15	6	14.1	50
GPC 08G03	8	G3/8	7	22.7	17.8	20	6	13	15	6	25.1	50
GPC 08G04	8	G1/2	8.5	23.7	17.8	24	6	13	15	6	41.9	50
GPC 10G01	10	G1/8	5	27.6	19.4	16	5	16	18.5	5	18.0	50
GPC 10G02	10	G1/4	6	28.3	19.4	16	6	16	18.5	6	20.7	50
GPC 10G03	10	G3/8	7	24.3	19.4	20	6	16	18.5	8	22.6	50
GPC 10G04	10	G1/2	8.5	24.8	19.4	24	6	16	18.5	8	39.9	50
GPC 12G01	12	G1/8	5	31.7	22.4	19	5	19.5	22.5	5	29.1	50
GPC 12G02	12	G1/4	6	32.4	22.4	19	6	19.5	22.5	6	32.3	50
GPC 12G03	12	G3/8	7	32.4	22.4	20	9	19.5	22.5	9	33.5	50
GPC 12G04	12	G1/2	8.5	28.9	22.4	24	10	19.5	22.5	10	41.1	25
GPC 14G03	14	G3/8	7	34.5	24.4	22	9	25	25	9	46.6	25
GPC 14G04	14	G1/2	8.5	36	24.4	24	11	25	25	11	57.0	25
GPC 16G03	16	G3/8	7	35.5	25	22	9	27	27	9	51.5	25
GPC 16G04	16	G1/2	8.5	36.5	25	24	11	27	27	11	56.9	25