

## Level Compensator

### Features and Strengths

The Vtec level compensator is used to compensate for differences in height on the surface of the material that is to be lifted. The advantages being a more reliable and less precise pick up position when handling product that may be less consistent in its shape, size and position. The level compensator also provides a degree of shock absorption should this be required. The level compensator comes in configurations with varying sizes of spring and stroke.



### 5-Series

#### Dimensional Information

Model	Thread Size	Stroke (in)	Weight (oz.)
L510T	M5-male	0.393	1.05
L520T	M5-male	0.787	1.1
L510	M5-male	0.393	1.1
L520	M5-male	0.787	1.2
L506TX	VB6X, VU1.5X, VU2X, VU4X	0.236	0.45
L506TS	VU10, VU15, VF15, VB10, VB12, VB15	0.236	0.47
L506TU	VU4, VU6, VU8, VB5, VB8	0.236	0.44
L506TM	VU2, VU3	0.236	0.44
L510LTX	VB6X, VU1.5X, VU2X, VU4X	0.393	0.68
L510LTS	VU10, VU15, VF15, VB10, VB12, VB15	0.393	0.69
L510LTU	VU4, VU6, VU8, VB5, VB8	0.393	0.67
L510LTM	VU2, VU3	0.393	0.67
L507T	M5-female	0.275	0.59
L515T	M5-female	0.59	0.7
L520TF	M5-female	0.787	0.67

L510T

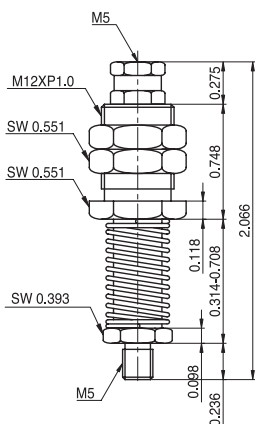

L520T

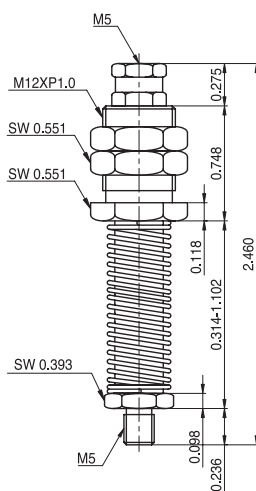

L510

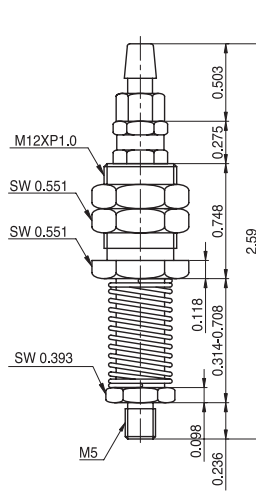

L520

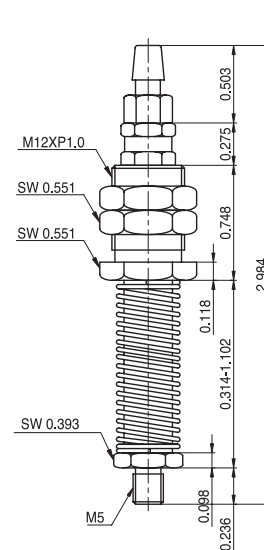

[ Measure unit : inch ]

## Dimensional Information

**L506TX**

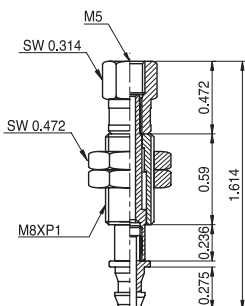

**L506TS**

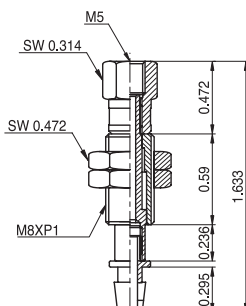

**L506TU**

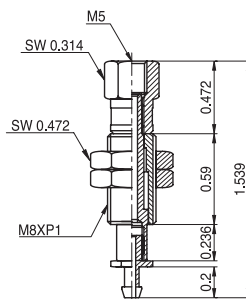

**L506TM**

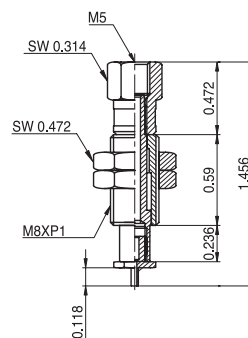

**L510LTX**

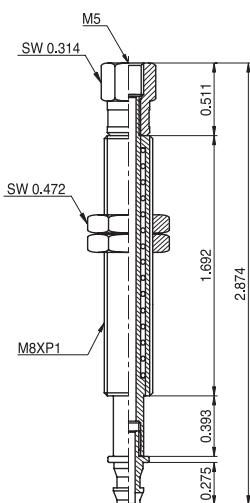

**L510LTS**

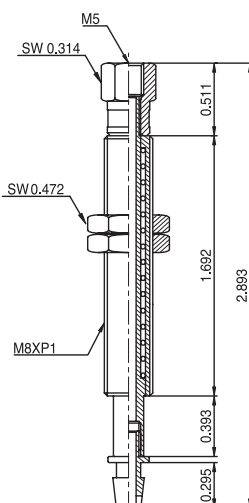

**L510LTU**

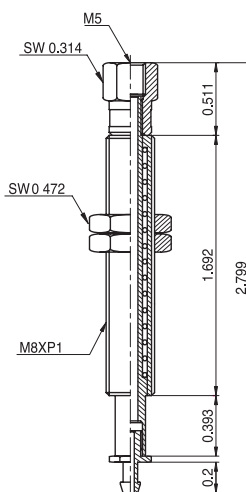

**L510LTM**

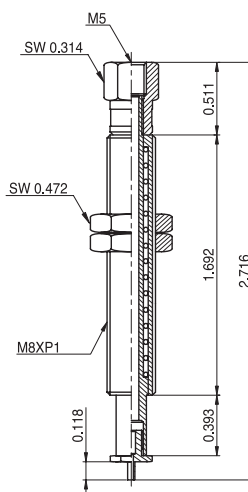

**L507T**

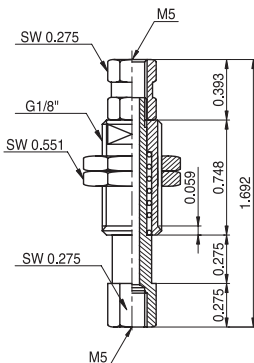

**L515T**

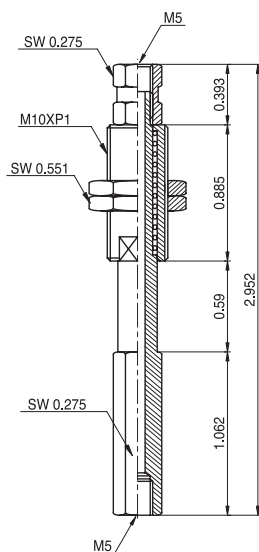

**L520TF**

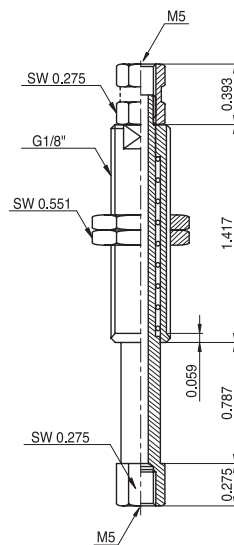

[ Measure unit : inch ]

SUCTION CUPS

## 18-Series

### Dimensional Information

Model	Thread Size	Stroke (in.)	Weight (oz.)
LN1805F	1/8" NPSF-female	0.196	0.84
L1805M	G1/8"-male	0.196	0.98
LN1810T	G1/8"-male	0.393	1.55
LN1810TS-M10F	M10-female	0.393	2.36
LN1810TS	G1/8"-male	0.393	2.57
LN1810TSE	G1/8"-male	0.393	3.28
L1815	G1/8"-male	0.59	3.03
LN1815T	G1/8"-male	0.59	1.79
LN1820T	G1/8"-male	0.787	2.85
LN1820TS	G1/8"-male	0.787	3.28
L1830	G1/8"-male	1.181	3.59
LN1830T	G1/8"-male	1.181	3.49
LN1830TS	G1/8"-male	1.181	4.58
L1850	G1/8"-male	1.968	3.7
LN1850T	G1/8"-male	1.968	4.4

**LN 1805F**

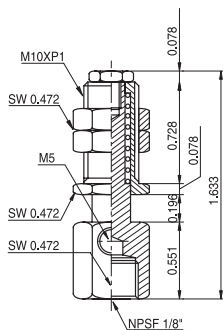

**L 1805M**

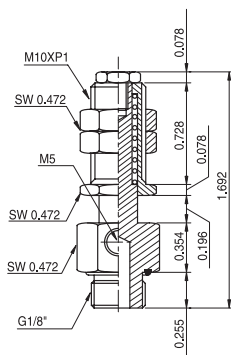

**LN 1810T**

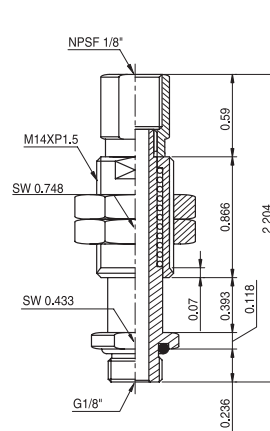

**LN 1810TS - M10F**

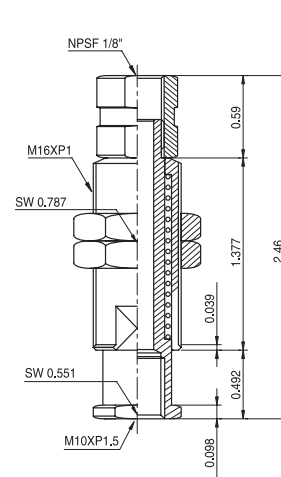

**LN 1810TS**

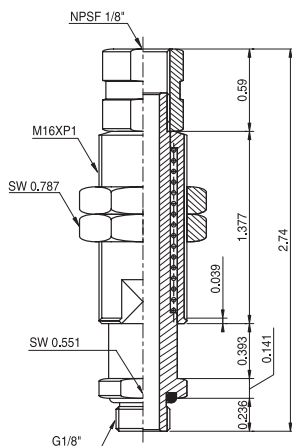

**LN 1810TSE**

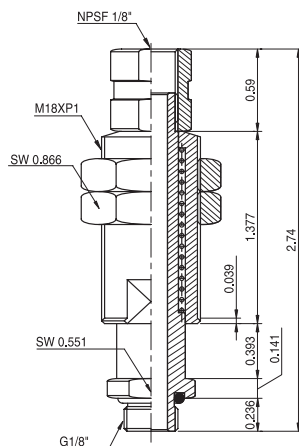

**LN 1815T**

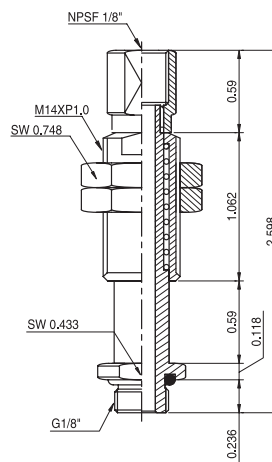

**LN 1815**

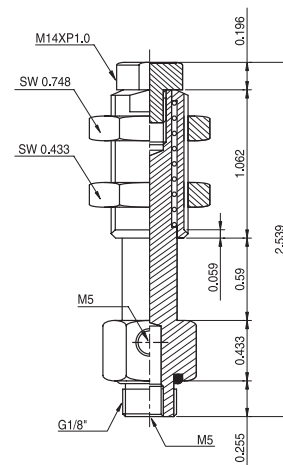

[ Measure unit : inch ]

## Dimensional Information

SUCTION CUPS

**LN 1820T**

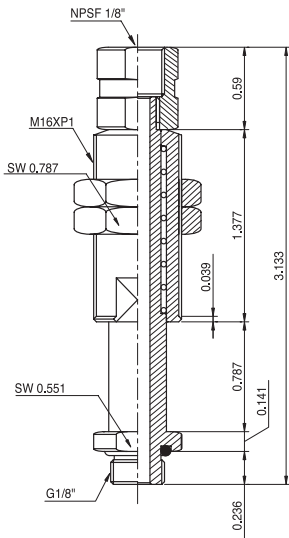

**LN 1820TS**

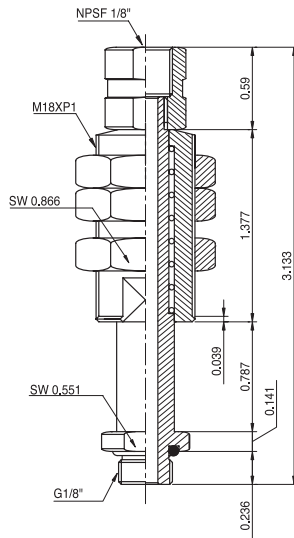

**LN 1830**

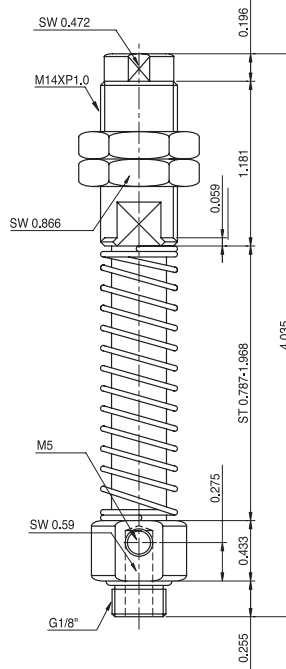

**LN 1830T**

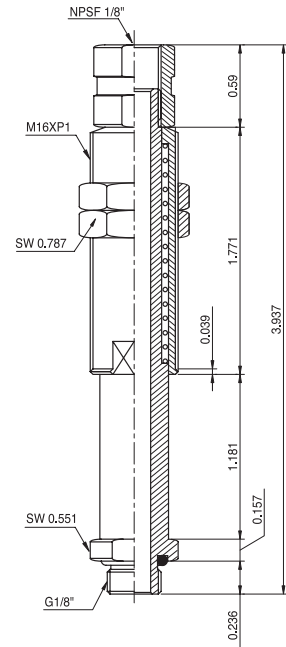

**LN 1830TS**

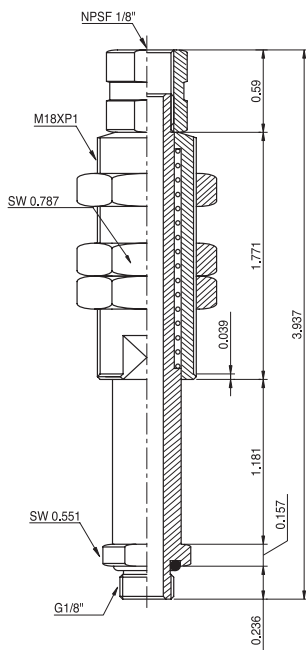

**LN 1850**

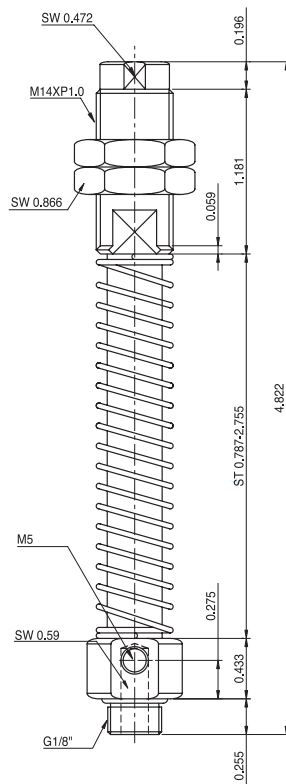

**LN 1850T**

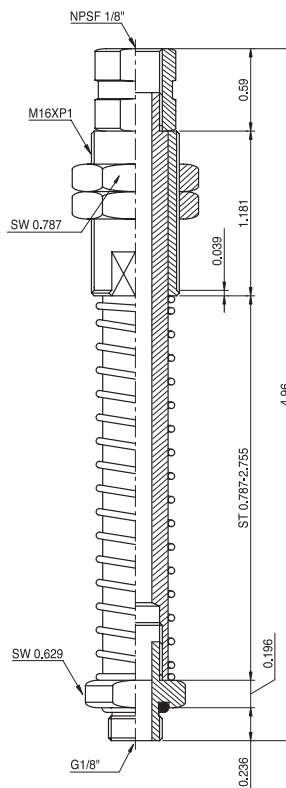

[ Measure unit : inch ]

## 12-Series

### Dimensional Information

Model	Thread Size	Stroke (in)	Weight (oz.)
LN1230	1/2" NPSM	1.181	10.1
LN1250	1/2" NPSM	1.968	12.3
LN1230T	1/2" NPSM	1.181	8.5
LN1250T	1/2" NPSM	1.968	7.58

LN 1230

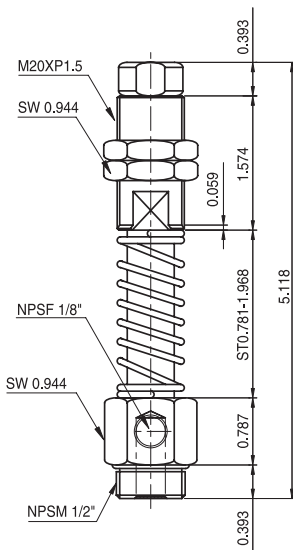

LN 1250

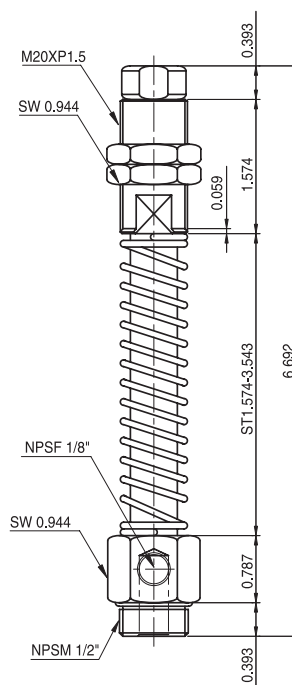

LN 1230T

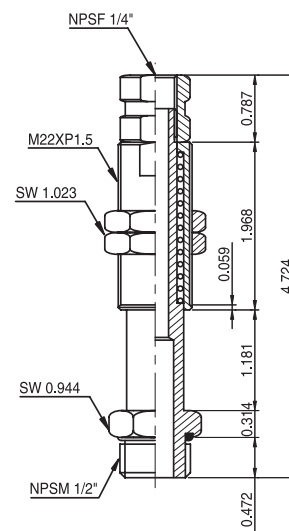

LN 1250T

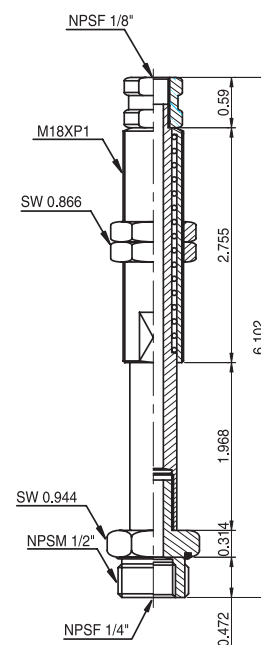

[ Measure unit : inch ]

## ■ Non Rotating Level Compensator

### Dimensional Information

Model	Thread Size	Stroke (in)	Weight (oz.)
L525TXN	VB6X, VU1.5X, VU2X, VU4X	0.984	0.73
L525TSN	VU10, VU15, VF15, VB10, VB12, VB15	0.984	0.72
L525TUN	VU4, VU6, VU8, VB5, VB8	0.984	0.71
L525TMN	VU2, VU3	0.984	0.71
L507TN	M5-female	0.275	0.63
LN1820TN	G1/8'-male	0.787	2.9

SUCTION CUPS

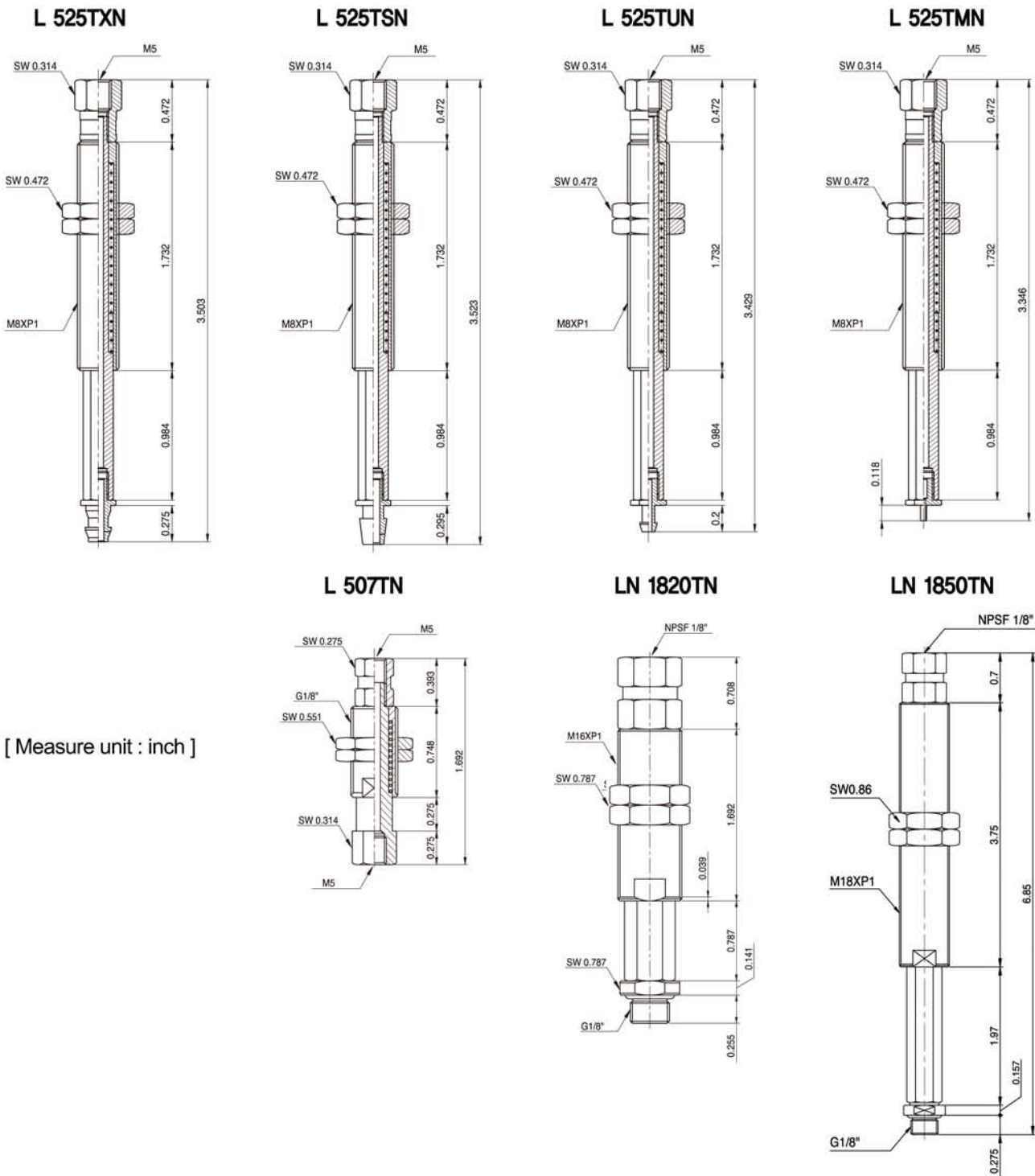

[ Measure unit : inch ]